



PROJ. NO.	CW146
REVISION	
DWG. BY	DMV
DATE	09/2019
SHEET	6 OF 7
DATE	
BY	C-5
DWG. NO.	

S & W MOTEL LIGHTING PLAN

CLEARWATER ENGINEERING
 PLANNING, DESIGN, CONSTRUCTION MGMT.
 P.O. BOX 251, SANDPOINT, IDAHO 83864
 (208) 255-8803

SCALE VERIFICATION:
 THESE PRINTS MAY BE REDUCED.
 LINE BELOW MEASURES ONE INCH
 ON ORIGINAL DRAWING.

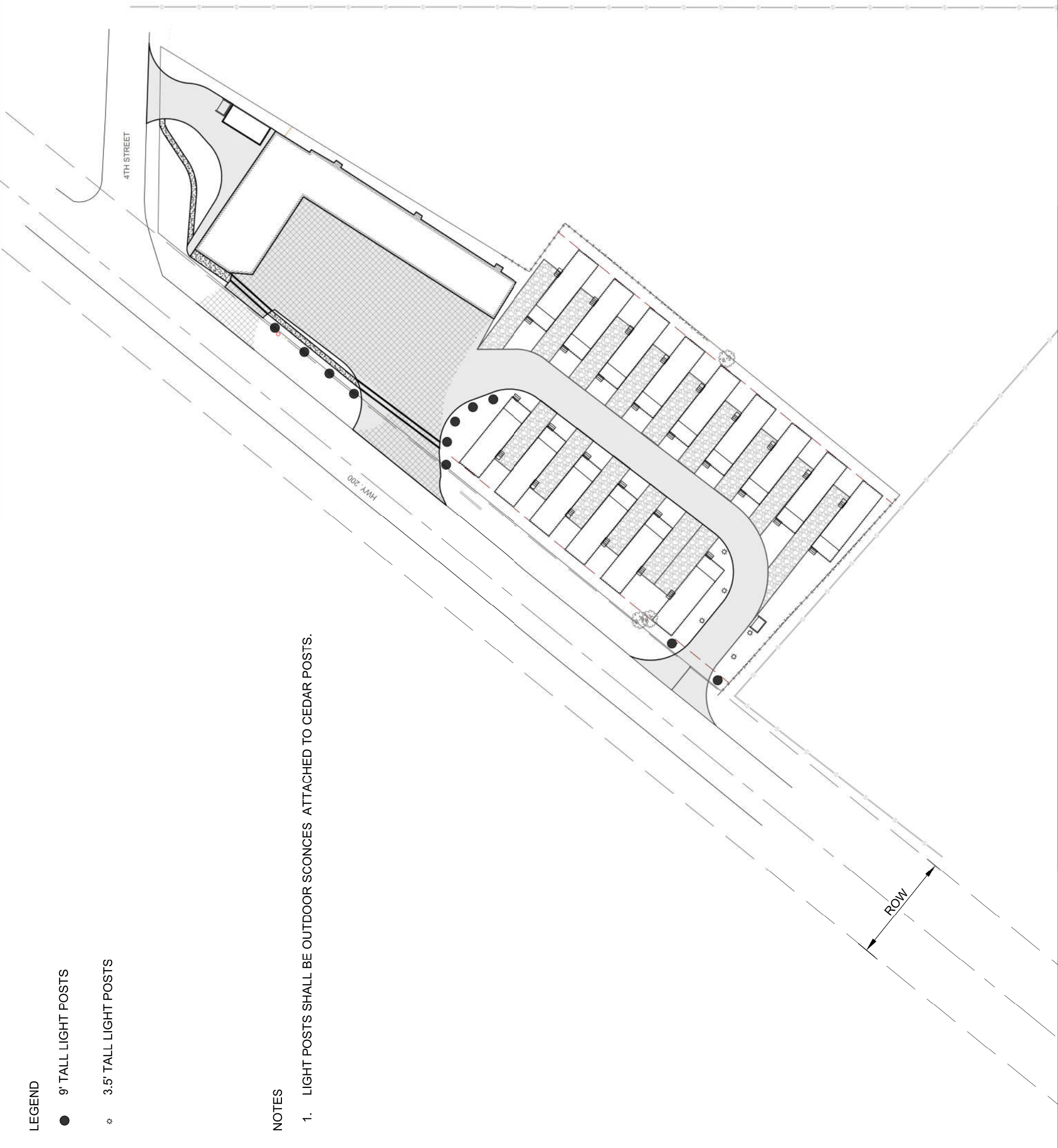

LEGEND

- 9' TALL LIGHT POSTS
- * 3.5' TALL LIGHT POSTS

NOTES

1. LIGHT POSTS SHALL BE OUTDOOR SCONCES ATTACHED TO CEDAR POSTS.